

DIGITAL ROYAL BAGGING SCALE

BY JEM INTERNATIONAL

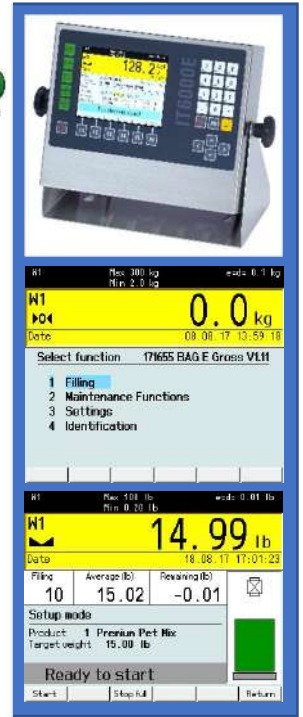

10 Bag per Minute, Easy to Operate Bagging Scale with “Smart Setup” to accurately weigh all your various products. US manufactured, two-speed bag filling system with record keeping, product traceability and data collection available.

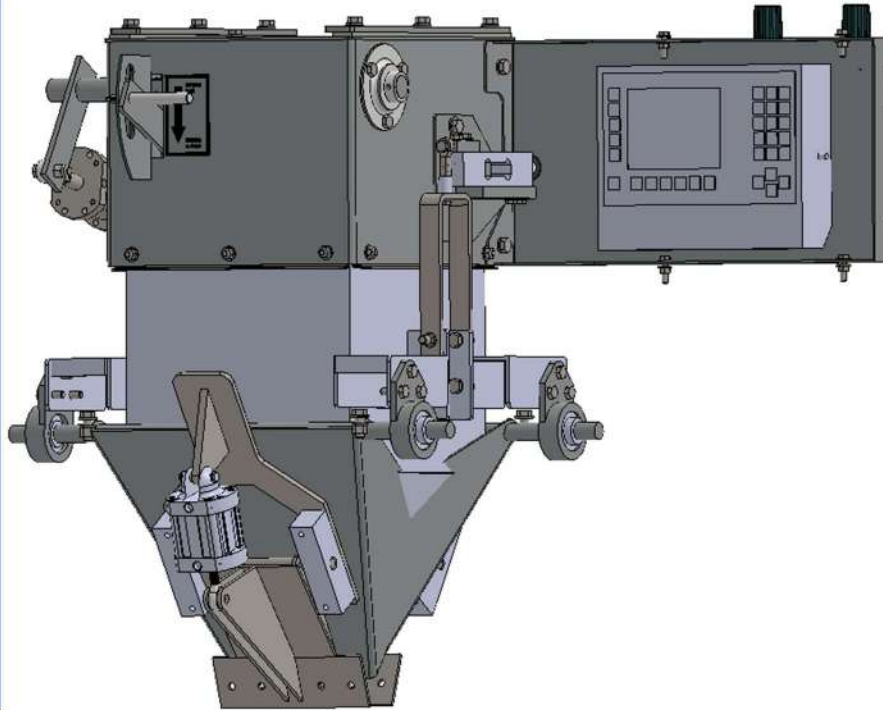

BENEFITS and FEATURES:

- 10 Bags per Minute with 0.2 lb/0.1 kg Weight Accuracy or 7 Bags per Minute with 0.1 lb/0.05 kg Weight Accuracy
- Two 100KG Load Cells with NIST test Weight Included
- Weights and Measures Approved, Stainless Steel Digital Controller
- 99 Memory-Retained Recipe Code Storage – 20 Character Name
- “Smart Setup” Ten Bag Start with Auto-Adjustment
- Bag Weight Data Collection with Product Name and Lot Number Tracking
- Bulk and Dribble Dual-Speed Gravity Gate Design for granular and pelleted products
- Belt, Auger and Vibratory Pan Feeders Available for Texturized, Cube, Flake, Powder, Flour and other Semi-Free Flowing Products
- Quick-Hang, Hand-Clearing, High Capacity Clam Shell Spout Design
- No Bag - No Fill Electrical Signal
- Same mounting pattern as GWM, GB32 and HR17 Mechanical Scales and GWD, JMDT, JM-FF-ED Digital Scales
- Designed for 10 pound to 110 pound (5 kg to 50 kg) Bag Weights
- Box and Pail Filling Adaptor Available
- Dust Tight Spouts and Dust Collection Ports Available
- RS 232-485 and TCP/IP Ports Available for Data Transfer and Printing
- Lab View Data Analysis Application Available for Purchase

DIGITAL ROYAL BAGGING SCALE

BY JEM INTERNATIONAL



SPECIFICATIONS AND TECHNICAL DATA:

- STAINLESS STEEL CONTROLLER – IP65 WITH 5.7" TFT COLOR DISPLAY
- LARGE WEIGHT DISPLAY AND INPUT LINES FOR 44 CHARACTERS
- WEIGHTS AND MEASURES APPROVED DATA ARCHIVE
- 99 MEMORY RETAINED RECIPE STORAGE
- MULTI-LANGUAGE OPERATOR PROMPTS, LB AND KG WEIGHING AND CALIBRATION
- RS-232 AND 485, USB AND RJ-45 COMMUNICATION PORTS
- 110 OR 220 VAC POWER SUPPLY *THREE-PHASE POWER RECOMMENDED FOR FEEDERS WITH MOTORS
- 14° F TO 104°F (-10°C TO +40°C) OPERATING TEMPERATURE
- CLAM SHELL BAG SPOUT WITH ADJUSTABLE DISCHARGE CIRCUMFERENCE
CS6: 26 INCH – 37 INCH DIAMETER OPENING OR CS10: 36 INCH – 44 INCH DIAMETER OPENING
21", 25" AND 31" DUST-TIGHT AND CENTER GRIP SPOUT CIRCUMFERENCES AVAILABLE
- FOOT PEDAL CLAMP ACTIVATION
- 9 INCH X 7 INCH (22.5 CM X 17.5 CM) PRODUCT CHUTE
- TWO SPEED BULK AND DRIBBLE FILL CYCLE
- SMART SETUP MODE AFTER PRODUCT CHANGE-OVER WITH AUTO WEIGHT ACCURACY ADJUSTMENT
- 12-24VAC LOW VOLTAGE CONTROLS WITH STEP-DOWN TRANSFORMER AND POWER SUPPLY INCLUDED
- ICCL HT-KD WOOD CERTIFICATION FOR EXPORT
- SHIPPING DIMENSIONS: 48"X 40"X 40" (120 CM X 100 CM X 100 CM) AT 250 POUNDS (114 KGS)
- MANUFACTURED IN THE UNITED STATES

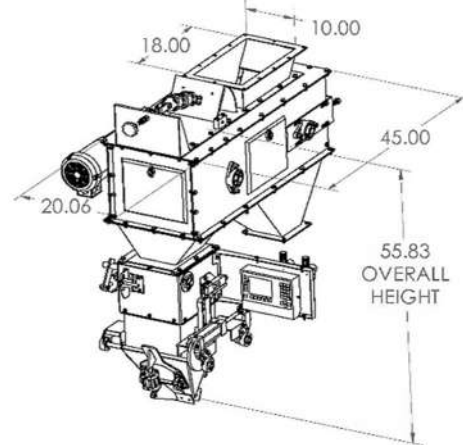
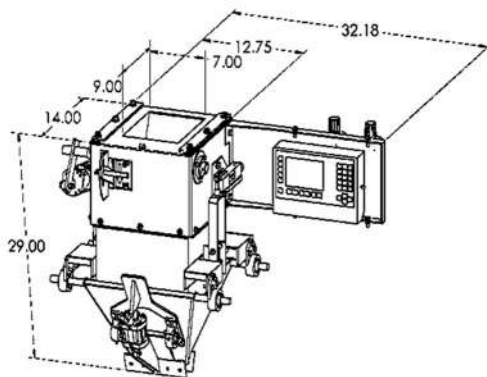

AVAILABLE OPTIONS:

- BELT, AUGER AND VIBRATORY PAN FEEDERS
- STAINLESS STEEL CONTACT OR ALL STAINLESS STEEL CONSTRUCTION
- AIR OPERATED DUST TIGHT SPOUT AND DUST COLLECTION PORT
- SCALE PEDESTAL AND SURGE HOPPERS
- BOX AND PAIL FILLING ATTACHMENT
- FOOD, PHARMACEUTICAL AND WASHDOWN UPGRADES
- PORTABLE FRAMEWORK WITH ADJUSTABLE HEIGHT BAG FILLING CONVEYOR
- WLAN AS OPTION, MODBUS TCP SLAVE AS OPTION, AND LABVIEW REPORTING APP AS OPTOIN
- BAG CLOSING EQUIPMENT
- START-UP AND TECHNICAL TRAINING

IT6000E



W&M Approved Weighing Terminal
For Gross and Net Weighing and Filling Applications

IT6000E - For Gross and Net Weighing and Filling Applications

Stainless steel housing IP69K

Suitable for harsh environment weighing locations.
With mounting brackets for desk-top or wall-mount installation. Integrated power supply unit, sealed cable glands for all cable connections.

Bright TFT color display

With wide viewing angle, large weight display and 4 to 8 input lines.



Simple and fast operation

Via integrated keyboard, function keys and soft keys, optional full-size PC keyboard (cable or Bluetooth).

Stationary or mobile use

With integrated 110 - 240VAC power supply unit or via external 12/24VDC battery.

Universal use

The W&M approved IT6000E is designed for demanding industrial applications in the chemical and pharmaceutical industry, in the food industry and in many other sectors of industry. The industrial design with the powerful modular hardware and the concept of free programmability make the IT6000E the ideal weighing terminal for standard or application-specific solutions, eg for:

- Shipping and receiving
- Filling of liquid and solid material
- Checkweighers
- Dynamic weighing and batching systems
- Vehicle weighing
- Mobile data capture systems.

Weighing electronics

1 or 2 internal scale interfaces possible.
Adjustable update rate with up to 800 updates / second. High noise immunity of min. 10V/m against radio frequency interference .
W&M approved resolution of up to 6000d with max. 80% preload. Calibration is possible as single or multiple-range (eg 3x3000d) and as multi-interval scale.
Internal data archive for the storage of up to 120,000 weighing transactions.

Modular concept

The modular design provides for a variety of configurations and options, such as:

- Enclosures for wall-mount, desk-top or panel-mount installation
- DC or AC power supply
- Connection of scales with analog or digital force transducers
- 10/100 Mbps Ethernet interface with integrated web server, WLAN as option
- Integrated USB 2.0 host interface for printer, scanner and USB stick
- Up to 2 serial interfaces, RS232, RS485, RS422, 20mA CL selectable
- Flexible I/O concept for up to 64 inputs and outputs
- Analog I/Os, etc.

This ensures that the optimal system configuration can be chosen, for stationary as well as mobile use.

Free programmability

Standard programs can be adapted to the requirements of specific applications.

New programs can be designed and tested in a very simple way on a PC with the RTC program development environment.

Simple integration

The Linux based operating system with the integrated web server provides the ideal functionality for the integration of the IT6000E into local area networks.

WLAN communication and remote access via internet are also possible.

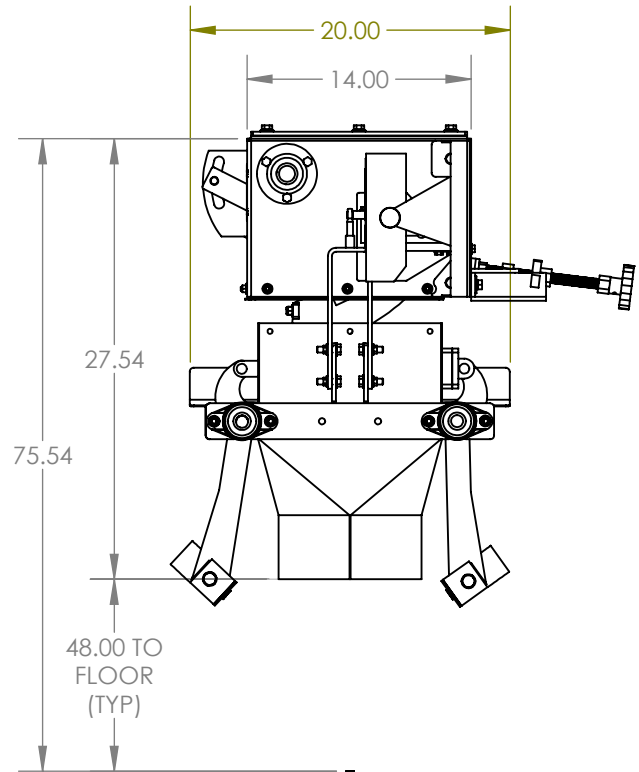
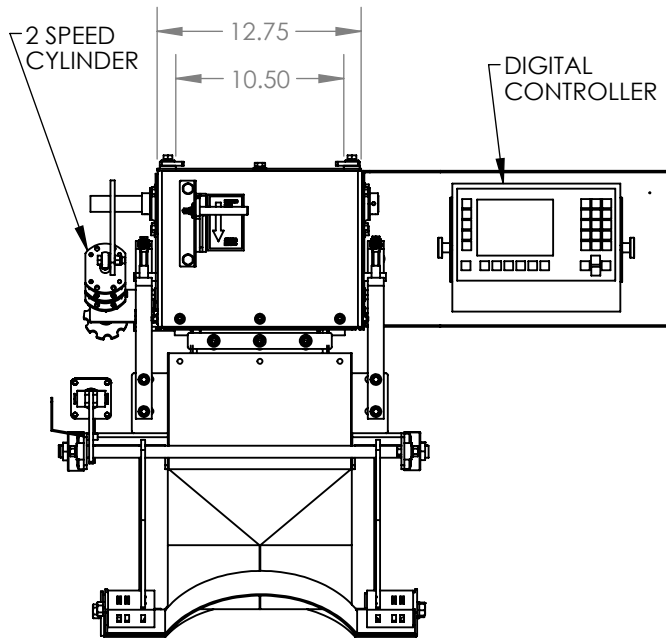
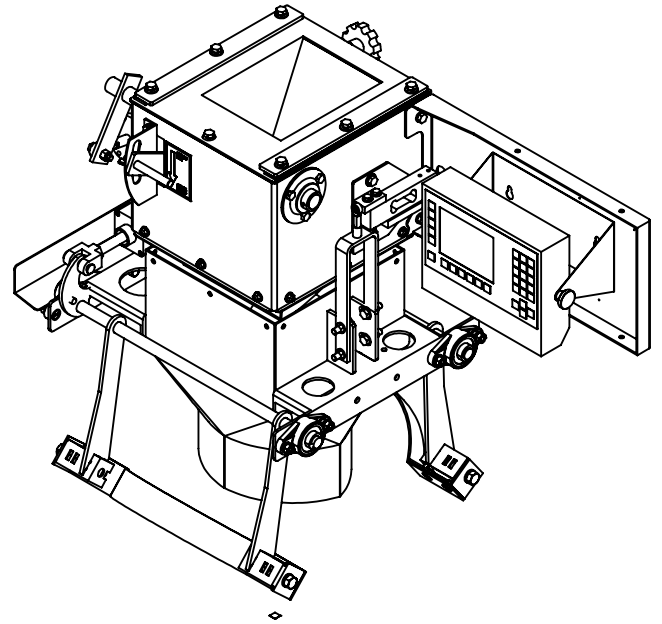
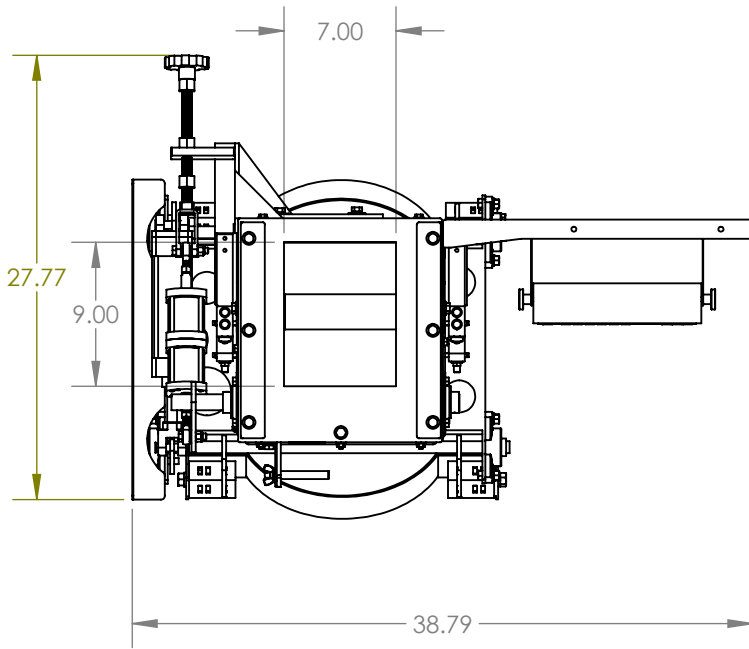

ELECTRICAL: 110-1-50/60 - 5 AMPS
220-1-50/60 - 5 AMPS
PNEUMATIC: 80 PSI 3-4 CFM

PROPRIETARY AND CONFIDENTIAL
THE INFORMATION CONTAINED IN THIS
DRAWING IS THE SOLE PROPERTY OF
JEM INTERNATIONAL, INC. ANY
REPRODUCTION IN PART OR AS A WHOLE
WITHOUT THE WRITTEN PERMISSION OF
JEM INTERNATIONAL, INC. IS
PROHIBITED.

		DIMENSIONS ARE IN INCHES TOLERANCES: FRACTIONAL \pm ANGULAR: MACH \pm BEND \pm TWO PLACE DECIMAL \pm THREE PLACE DECIMAL \pm
		MATERIAL
		FINISH
NEXT ASSY	USED ON	
APPLICATION		DO NOT SCALE DRAWING

	NAME	DATE
DRAWN	TAB	20SEP2018
CHECKED		
ENG APPR.		
MFG APPR.		
Q.A.		
COMMENTS:		

JEM INTERNATIONAL, INC.

DIGITAL ROYAL
DUST TIGHT SPOUT

SIZE	DWG. NO.	REV.
A	DIGITAL ROYAL DT	
SCALE: 1:12	WEIGHT:	SHEET 1 OF 1